

TACFLEX FLEXIBLE CONDUIT FITTINGS



## LIQUID TIGHT SPIRAL CONDUITS FITTINGS NPT WITH CABLE HOLDER MALE/FEMALE

### TECHNICAL DETAILS

<b>Material</b>	
Cap nut	: Brass with nickel plated
Clamping insert	: PA6
Sealing ring	: TPV
Ring	: Polyethylene
Ferrule	: Aluminium / Galvanised
Gland body	: Brass with nickel plated
O-ring	: NBR
Connection thread	: NPT ANSI B1.20.1
Protection class	: IP67
Temperature range	: -30 °C +100 °C
Certificates	

### Properties

Easy to assemble  
Fixed or swivel body versions  
Apply with either LGT or CTS, CTPS type conduits  
**AĞIR HİZMET KABLO TUTUCULU SİRAL BORU RAKORU PANO TİPİ (ERKEK) & DIŞİ (BORU) TİPİ**

Hammaddesi	: Piring, nikel kaplı
Bağlantı dişi NPT	: NPT ANSI B1.20.1
Koruma sınıfı	: IP67
O-ring	: Nitril kauçuk
Uygun spiral	: LGT-CTS-CTPS

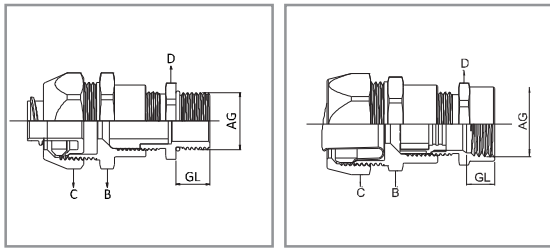

### NPT / MALE TYPE

Code	NPT Thread	Spiral Measure	GL mm.	B mm.	C mm.	D mm.	Cables mm.
MLSRN 00	1/4"	10 - 1/4"	10	20	22	14	3-6,5
MLSRN 1A	3/8"	10 - 1/4"	10	20	22	18	4-8
MLSRN 01	3/8"	13 - 3/8"	11,5	24	26	20	5-10
MLSRN 2A	1/2"	16 - 1/2"	13	27	29	22	6-12
MLSRN 02	1/2"	16 - 1/2"	13	27	29	24	10-14
MLSRN 03	3/4"	21 - 3/4"	15	33	35	30	13-18
MLSRN 04	1"	26 - 1"	15	43	45	40	18-25
MLSRN 05	1 1/4"	35 - 1 1/4"	16	52	54	50	22-32
MLSRN 06	1 1/2"	40 - 1 1/2"	18	60	63	55	30-38
MLSRN 07	2"	51 - 2"	20	74	77	65	33-44
MLSRN 08	2 1/2"	63 - 2 1/2"	20	90	90	75	45-55
MLSRN 09	3"	78 - 3"	24	105	110	90	50-63
MLSRN 10	4"	102 - 4"	30	136	140	100	60-70

### NPT / FEMALE TYPE

MLSRND 00	1/4"	10 - 1/4"	10	20	22	14	3-6,5
MLSRND 1A	3/8"	10 - 1/4"	10	20	22	18	4-8
MLSRND 01	3/8"	13 - 3/8"	11,5	24	26	20	5-10
MLSRND 2A	1/2"	16 - 1/2"	13	27	29	22	6-12
MLSRND 02	1/2"	16 - 1/2"	13	27	29	24	10-14
MLSRND 03	3/4"	21 - 3/4"	15	33	35	30	13-18
MLSRND 04	1"	26 - 1"	15	43	45	40	18-25
MLSRND 05	1 1/4"	35 - 1 1/4"	16	52	54	50	22-32
MLSRND 06	1 1/2"	40 - 1 1/2"	18	60	63	55	30-38
MLSRND 07	2"	51 - 2"	20	74	77	65	33-44
MLSRND 08	2 1/2"	63 - 2 1/2"	20	90	90	75	45-55
MLSRND 09	3"	78 - 3"	24	105	110	90	50-63
MLSRND 10	4"	102 - 4"	30	136	140	100	60-70

PRODUCT RANGE OVERVIEW