

ORTAC METAL VENTILATION ELEMENTS

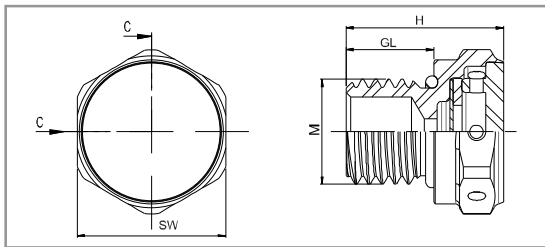

ORvent



VENTILATION PLUGS BRASS

TECHNICAL DETAILS

Material

Cap & body : Brass nickel plated
 O-ring : NBR / EPDM
 Vent Part : Acrylic Co-Polymer on Nylon Support (Hydrophobic-Oleophobic)

Connection thread

: Metric (EN 60423)

Certificates

: ROHS,CE,PT,TUV

Protection class

: IP68

Temperature range

: -20 °C +100 °C -30 +150 °C (short term)

Benefits

- Balance the pressure inside and outside of your systems
- Prevents corrosion and water condensation inside the enclosure
- Extend the lifetime of your product
- Various air flows
- Easy to assemble
- High chemical resistance

Applications

- Industrial and electronic applications
- Wind & Solar applications
- Lighting Industry
- Automotive & Automation technology
- Railway industry

VENTILATION PLUGS

PRODUCT RANGE OVERVIEW

| AG Thread | Code | H mm | GL mm | mm | Thread Diameter mm | Hole Diameter mm | Average Air Flow l/H | Water Intrusion mbar |
|------------|------------|------|-------|----|--------------------|------------------|----------------------|----------------------|
| M 4 x 0,70 | OMBVP4S | 10 | 3 | 12 | 4 | 4,2 | 6 | 0,1 |
| M 4 x 0,70 | OMBVP4M | 10 | 3 | 12 | 4 | 4,2 | 9 | 0,1 |
| M 4 x 0,70 | OMBVP4H | 10 | 3 | 12 | 4 | 4,2 | 45 | 0,1 |
| M 4 x 0,70 | OMBVP4UH | 10 | 3 | 12 | 4 | 4,2 | 105 | 0,1 |
| M 8 x 1,25 | OMBVP8S | 13 | 6 | 12 | 8 | 8,2 | 6 | 0,1 |
| M 8 x 1,25 | OMBVP8M | 13 | 6 | 12 | 8 | 8,2 | 9 | 0,1 |
| M 8 x 1,25 | OMBVP8H | 13 | 6 | 12 | 8 | 8,2 | 45 | 0,1 |
| M 8 x 1,25 | OMBVP8UH | 13 | 6 | 12 | 8 | 8,2 | 105 | 0,1 |
| M 10 x 1,5 | OMBVP10S | 13 | 6 | 12 | 10 | 10,2 | 6 | 0,1 |
| M 10 x 1,5 | OMBVP10M | 13 | 6 | 12 | 10 | 10,2 | 9 | 0,1 |
| M 10 x 1,5 | OMBVP10H | 13 | 6 | 12 | 10 | 10,2 | 45 | 0,1 |
| M 10 x 1,5 | OMBVP10UH | 13 | 6 | 12 | 10 | 10,2 | 105 | 0,1 |
| M 12 x 1,5 | OMBVP01S | 14 | 6 | 17 | 12 | 12,3 | 16 | 0,8 |
| M 12 x 1,5 | OMBVP01M | 14 | 6 | 17 | 12 | 12,3 | 25 | 0,5 |
| M 12 x 1,5 | OMBVP01H | 14 | 6 | 17 | 12 | 12,3 | 150 | 0,2 |
| M 12 x 1,5 | OMBVP01UH | 14 | 6 | 17 | 12 | 12,3 | 300 | 0,1 |
| M 12 x 1,5 | OMBVP01SL | 18 | 10 | 17 | 12 | 12,3 | 16 | 0,8 |
| M 12 x 1,5 | OMBVP01ML | 18 | 10 | 17 | 12 | 12,3 | 25 | 0,5 |
| M 12 x 1,5 | OMBVP01HL | 18 | 10 | 17 | 12 | 12,3 | 150 | 0,2 |
| M 12 x 1,5 | OMBVP01UHL | 18 | 10 | 17 | 12 | 12,3 | 300 | 0,1 |